

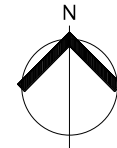

GILLETT PLACE

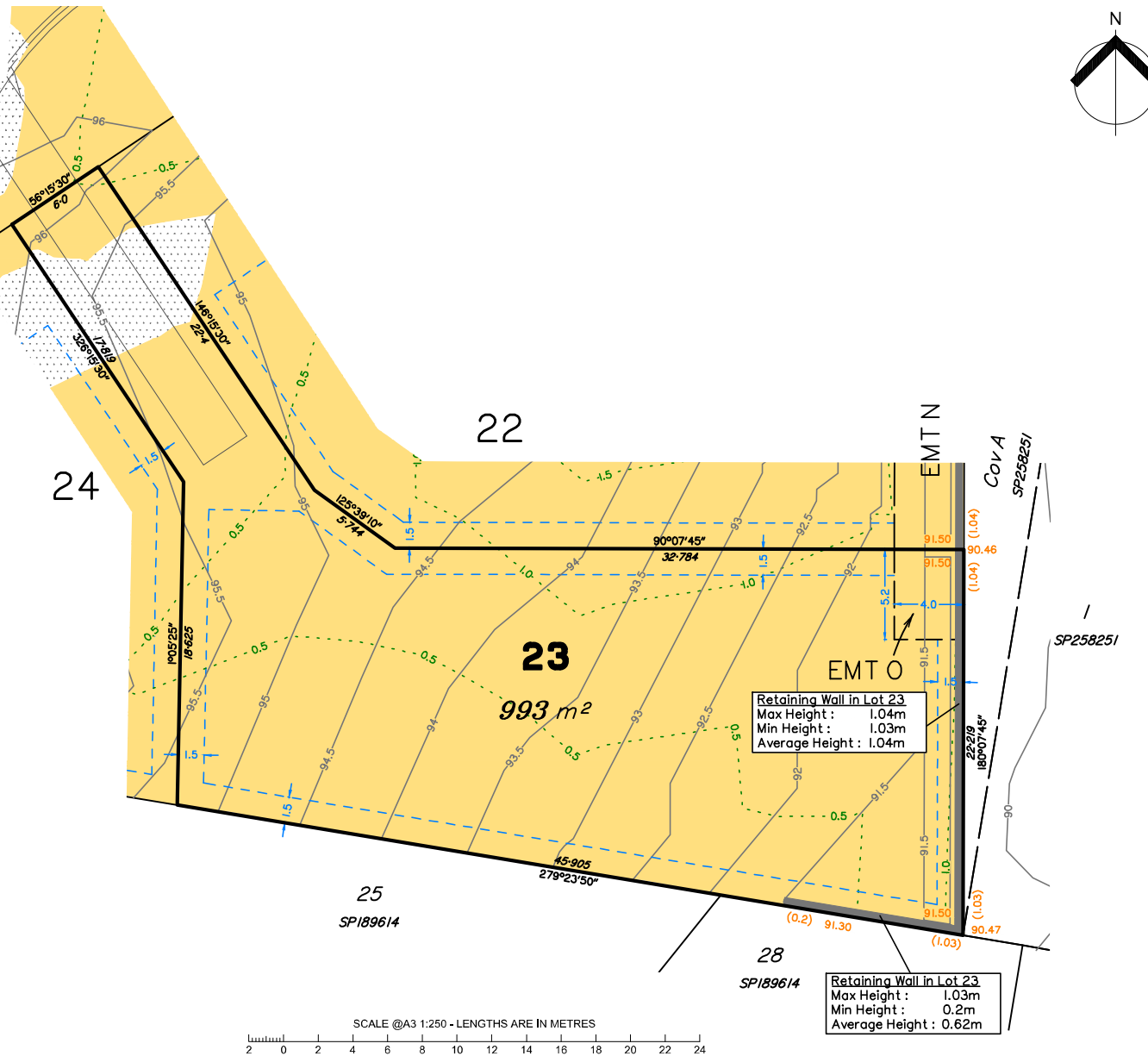

LEGEND

- Area of Fill
- Area of Cut
- Design Contours
- Depth of Fill Contours
- Retaining Wall
(Height shown in brackets on lower side)
- Finished Surface Design Level
- Future Lot Boundary
- Building Envelope
(Refer to Scenic Rim Planning Scheme - 9.3.5 Dwelling House Code, for further details)

(Not all items in this legend may be relevant to the lot shown hereon)

NOTES

This plan has been prepared from preliminary survey plan (SP324818) and engineering plans provided on the 17/09/2020 by Civil360 Engineering Pty Ltd.

Development approval was granted for this subdivision by the Scenic Rim Regional Council on 3rd February 2020. (Application Reference: RAL 19/032).

At the time of publication of this plan, development approval for operational works has been granted.

The purchaser should refer to the applicable development approvals for building and/or other requirements that may be applicable to the lot.

All fill shall be placed and compacted in a controlled manner so that Level 1 level of responsibility may be achieved and certified as per AS3798-2007.

Lot 23 contains Emt O on SP324818 for services benefiting Scenic Rim Regional Council.



STAGE 2

No.	by	Date	Description
A	TBG	03/03/21	Original Issue



Saunders Havill Group Pty Ltd ABN 24 144 972 949
 Brisbane @ Springfield @ Rockhampton
 head office 9 Thompson St Bowen Hills Q 4006
 phone 1300 123 SHG web www.saundershavill.com

This Disclosure Plan is prepared for the sole purpose of satisfying the disclosure requirements of the Land Sales Act and SHOULD NOT be used for any other purpose, particularly as-constructed purposes. This information is compiled from design plans only, unless otherwise stated, and therefore is subject to final survey and construction of operational works.

Disclosure Plan for Proposed Lot 23 on SP324818

Described as part of Lot 2 on SP258251
 Existing Title Reference: 50916300

Locality of Dugandan (Scenic Rim Regional Council)

Level Datum: AHD der.
 Origin of Levels: PSM9565
 RL of Origin: 111.304
 Contour Interval: 0.5m
 Scale @A3 1: 250
 Dwg No. 9666 S 06 DP A_23